

LONGITUDINAL WALL SECTION 05

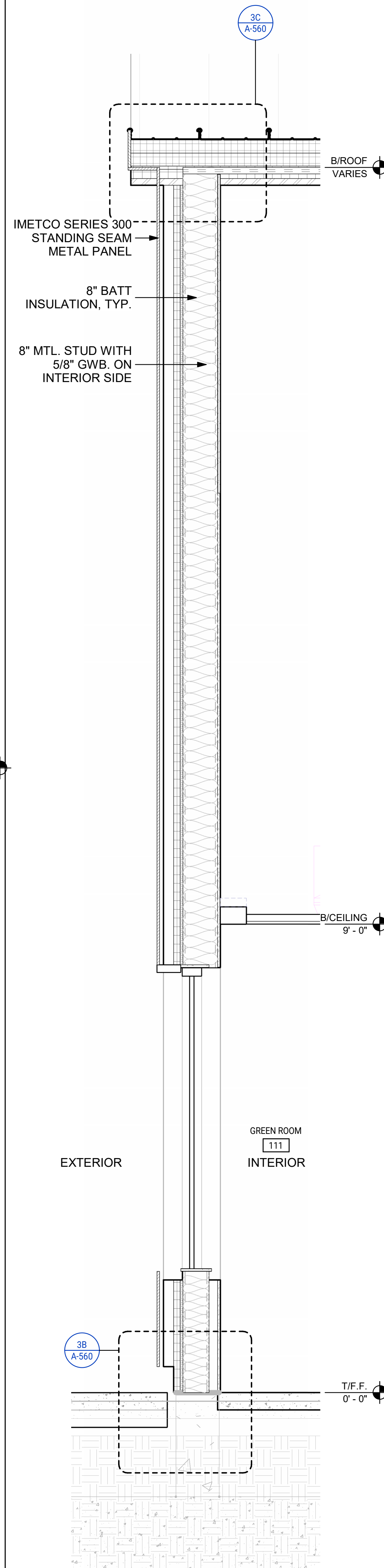

**LONGITUDINAL WALL SECTION 04**  
SCALE: 3/4" = 1'-0"

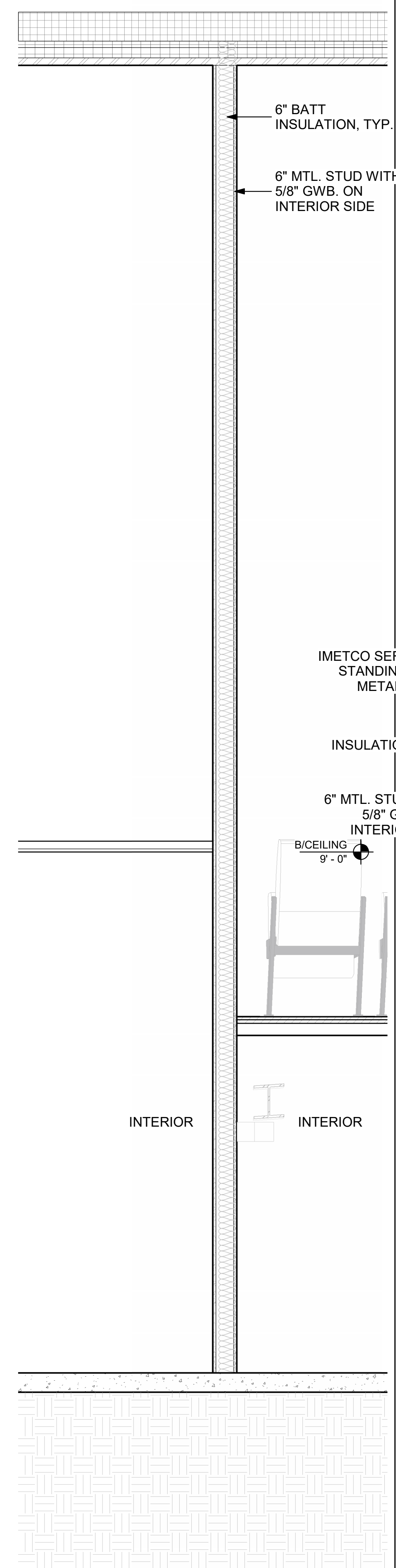

LONGITUDINAL WALL SECTION 03

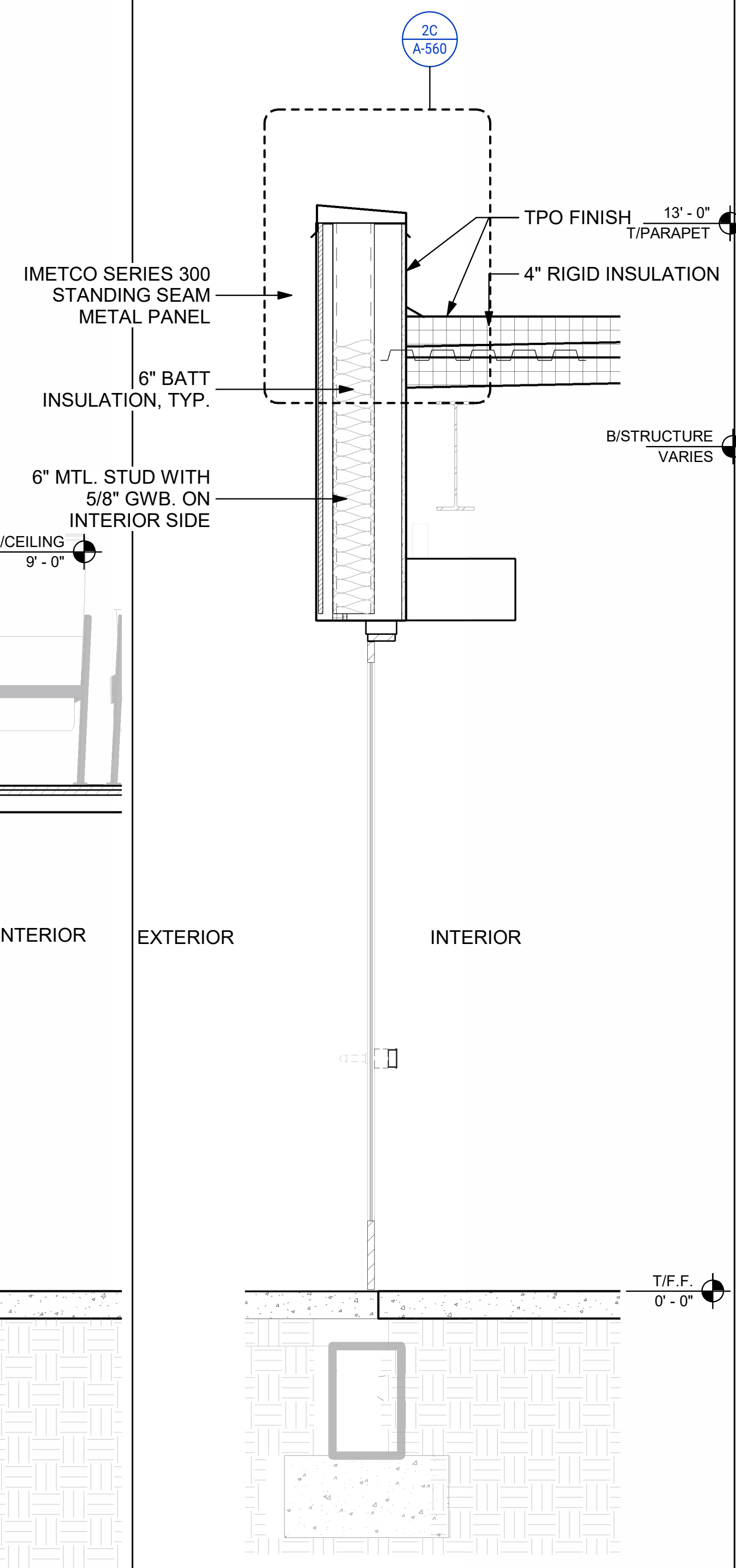

LONGITUDINAL WALL SECTION 02

SCALE: 3/4" = 1'-0"

2A

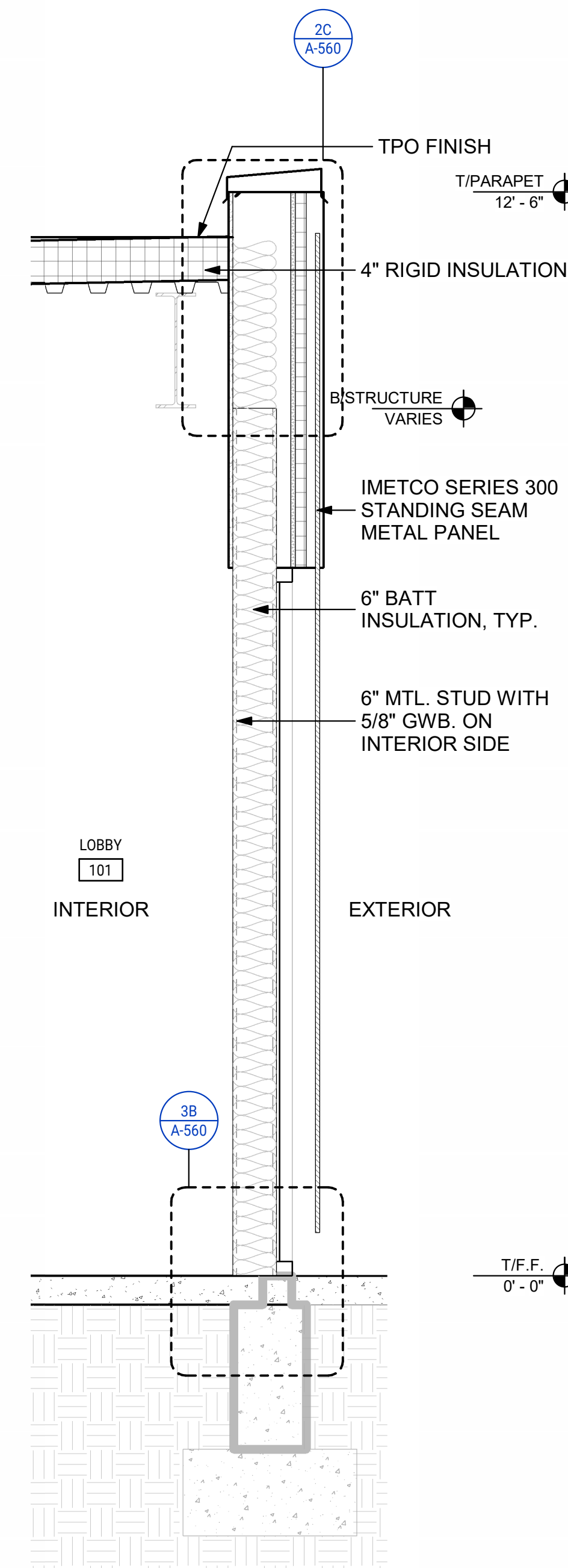

LONGITUDINAL WALL SECTION 01